

### OUTPUT

$\phi 1.375\text{in}$   
[34.93mm]  
C.A.

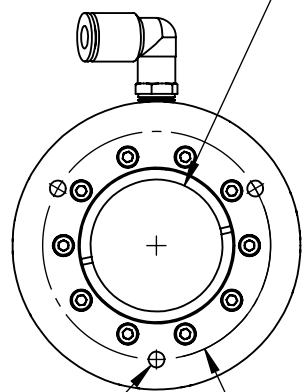

$\phi 2.375\text{in}$   
[60.33mm]

3X M5X0.8  $\nabla .394\text{in}$  [10mm]

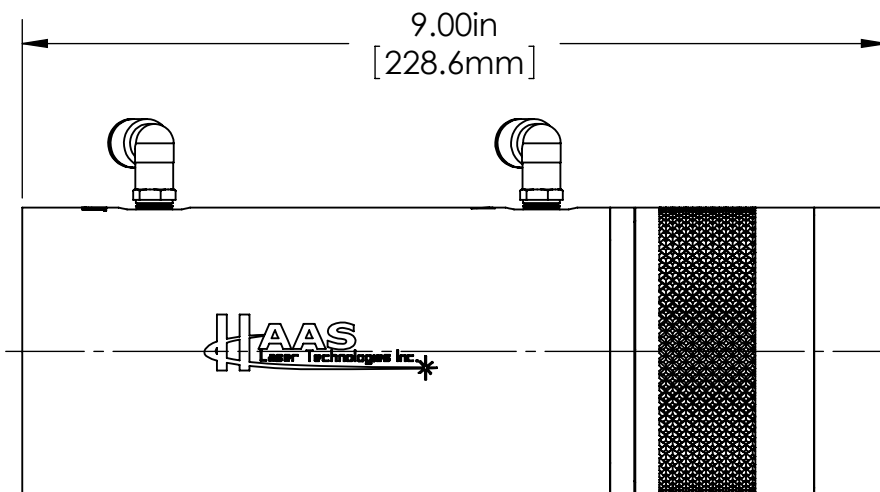

FOCUS CONTROL

### INPUT

$\phi .940\text{in}$   
[23.88mm]  
C.A.

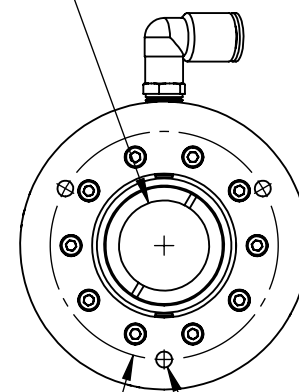

$\phi 2.375\text{in}$   
[60.33mm]

3X M5X0.8  $\nabla .394\text{in}$  [10mm]

FOR INFORMATION ONLY  
NOT FOR MANUFACTURING

DATE:  
3/3/2017

DRAWN BY:  
MPM

CHK'D BY:  
RS

TOLERANCES:  
(EXCEPT AS NOTED)

X.XXX =  $\pm 0.005$

X.XX =  $\pm 0.01$

X X/X =  $\pm 1/64$

ANGULAR:  $\pm 0.5^\circ$

NO.

REVISIONS

DATE

APPD

HAAS DOC.# BEC-38-2.5-10.6-W

SPECIFICATIONS SUBJECT TO CHANGE WITHOUT  
NOTICE. CONTACT HAAS LTI FOR MORE INFORMATION.



37 IRONIA ROAD  
FLANDERS NJ 07836  
(973) 598-1150  
Fax: 598-1151

BEC-38-2.5-10.6-W WATER COOLED  
CUSTOMER DIMENSIONAL INFO

BOM#  
NA

SCALE: 1:2